

## Data Sheet

# H-Piece Valves Type RLV-KS for Valve Radiators in Two-Pipe Systems

### Application



RLV-KS straight, 1/2" and 3/4" connection

RLV-KS angle, 1/2" and 3/4" connection

By means of the H-piece valve type RLV-KS, every valve radiator with a centre distance between the connections of 50 mm can be blocked individually, e.g. in order to carry out trouble-free maintenance without affecting other parts of the system.

H-piece valve type RLV-KS is nickel plated and is available in straight and angle versions. The H-piece can be used directly for radiators with an external thread of 3/4". With a self-sealing adapter the H-piece can be used for radiators with an internal thread of 1/2" as well.

Connection to copper, soft steel, PEX and Alupex pipes is made with Danfoss compression fittings (see separate datasheet). All connections are self-sealing.

Connection to system pipes in accordance to DIN V 3838.

In order to avoid deposition and corrosion, the composition of the hot water should be in accordance with the VDI 2035 guideline (Verein Deutscher Ingenieure).

### System

Two-pipe system

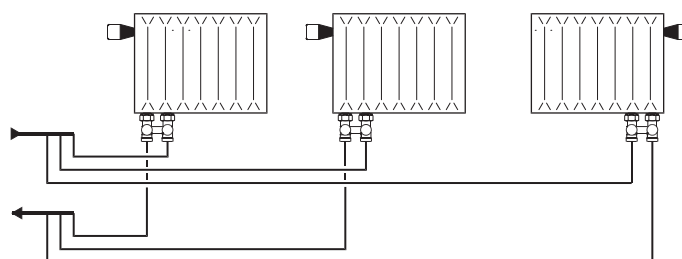

### Data and Ordering

Type	Version	Connection		Max. operation pressure	Test pressure	Max. water temperature	k <sub>vs</sub>	Code no.
		Radiator	System					
RLV-KS	Angle	G 1/2	G 3/4	10 bar	16 bar	120 °C	1.3 m <sup>3</sup> /h	003L0222
	Straight							003L0220
	Angle	G 3/4 A	G 3/4					003L0223
	Straight							003L0221

Accessories

Product		Code no.
Self-sealing connection nipple, G $\frac{1}{2}$ A / G $\frac{3}{4}$ A external thread <sup>1)</sup>		003L0297

<sup>1)</sup> Packing size = 20 pcs.

Design

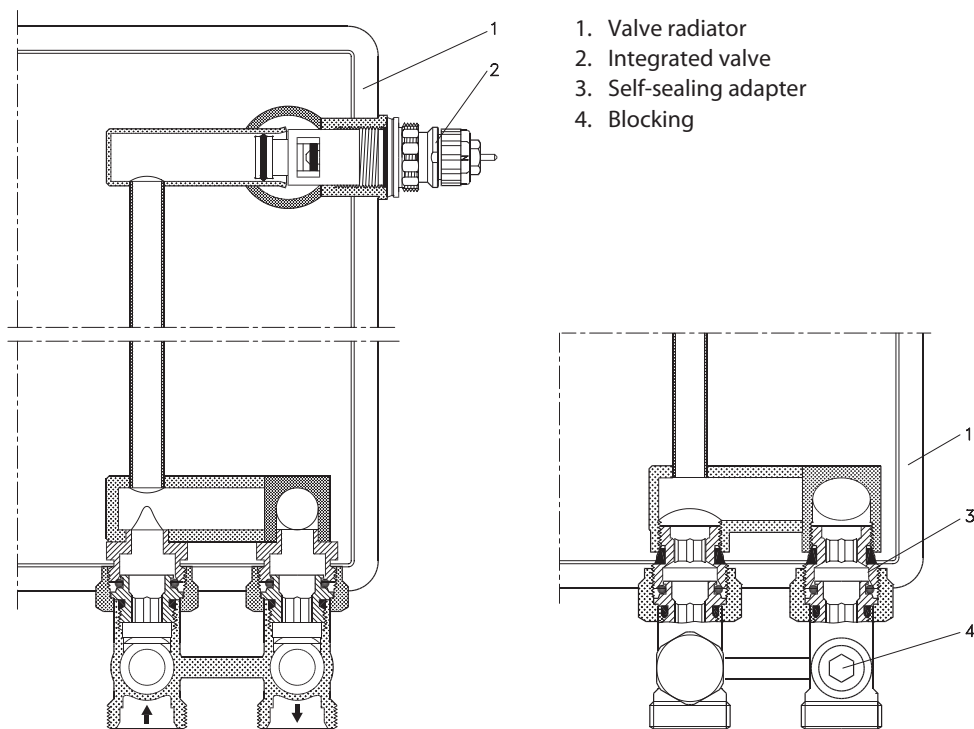

- 1. Valve radiator
- 2. Integrated valve
- 3. Self-sealing adapter
- 4. Blocking

**Materials in contact with water**

Valve body and other metal parts	Ms 58
O-ring	EPDM

Dimensions

*RLV-KS straight, G 1/2 A radiator connections*

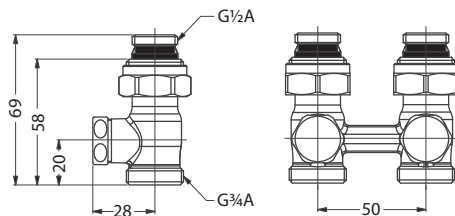

*RLV-KS angle, G 1/2 A radiator connections*

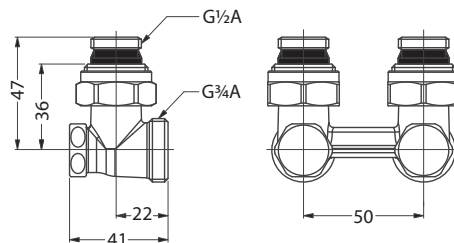

*RLV-KS straight, G 3/4 radiator connections*

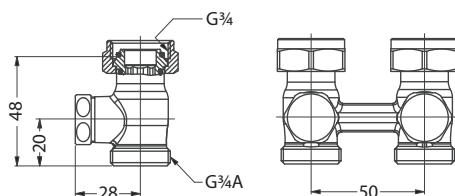

*RLV-KS angle, G 3/4 radiator connections*

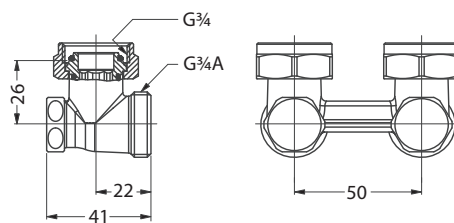

Danfoss A/S  
Heating Solutions  
Haarupvaenget 11  
8600 Silkeborg  
Denmark  
Phone: +45 7488 8000  
Fax: +45 7488 8100  
Email: [heating.solutions@danfoss.com](mailto:heating.solutions@danfoss.com)  
[www.heating.danfoss.com](http://www.heating.danfoss.com)

---

Danfoss can accept no responsibility for possible errors in catalogues, brochures and other printed material. Danfoss reserves the right to alter its products without notice. This also applies to products already on order provided that such alterations can be made without subsequential changes being necessary in specifications already agreed. All trademarks in this material are property of the respective companies. Danfoss Heating Solutions and the Danfoss Heating Solutions logotype are trademarks of Danfoss A/S. All rights reserved.

---